

## Dimension

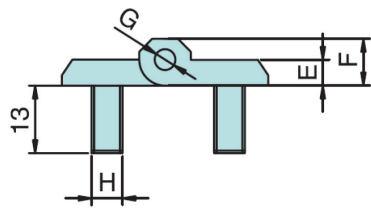

98226-1A

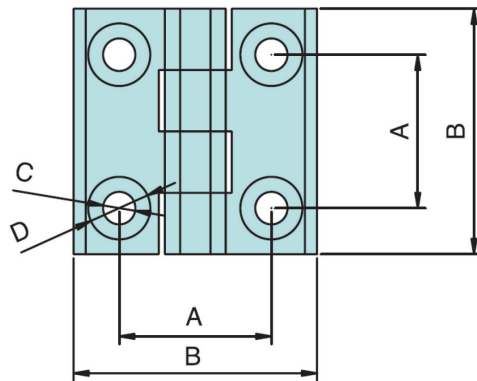
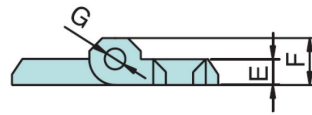

98226-1

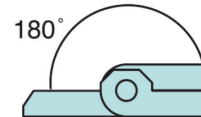
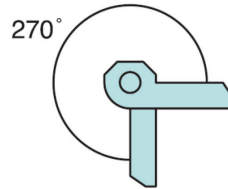
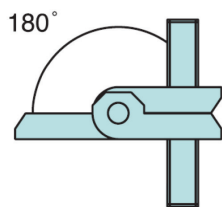

Item NO.		A	B	C	D	E	F	G	H	Load rating (kg)
98226-1	98226-1A	36	60	8.4	16.5	8	15	8	M8	40
98226-2	98226-2A	30	50	6.3	12.5	6	11.5	6	M6	30
98226-3	98226-3A	25	40	5.2	10.2	5	9	4	M5	20